

## CHARACTERISTICS

Robustly constructed, safely sealed pumps designed for data center cooling applications. They feature superior performance, a compact design and die-cast aluminum housing and motor base. Integrated Field Oriented Control (FOC) motor driver provides high efficiency, reliable operations and intelligent features such as over voltage protection and over current protection. These centrifugal pumps are ideal for a variety of applications including data center direct to chip cooling, coolant distribution unit and more.



## APPLICATION

Data Cooling / Direct to Chip / Coolant Distribution Unit



## SPECIFICATIONS

■ Nominal power:	80W
■ Nominal voltage:	48V
■ Operation voltage:	36 to 60V
■ Current consumption:	< 2A
■ Hydraulic power:	18W
■ Coolant:	Water glycol mixture 50:50 by volume
■ Flowrate:	10LPM
■ Pressure drop:	110kPa
■ Temperature coolant:	-40° to 100°C
■ Temperature ambient:	-40° to 70°C
■ IP Grade:	IP55
■ Diameter & Length:	81.6mm / 140mm

## PERFORMANCE

Model	Rated Flow Rate (LPM)	Pressure Drop (Kpa)	Voltage (VDC)	Current (A)	Input power (W)
<b>WP80</b>	10	110	48	1.67	80

1. Temperature Coolant: -40C~100C 2. PWM Speed Control 3. IP55

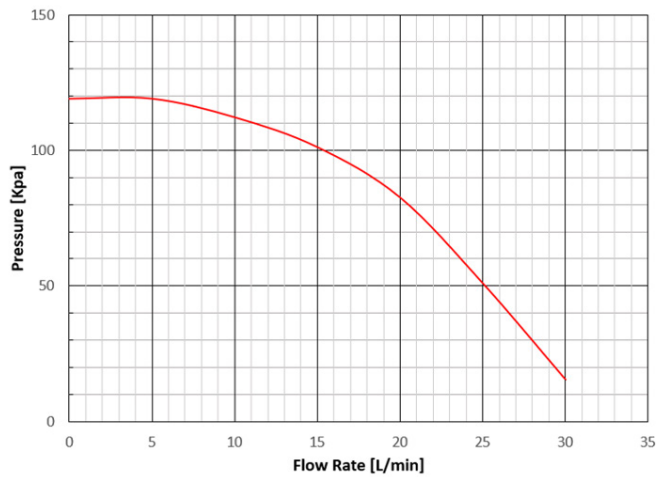

## DRAWING:

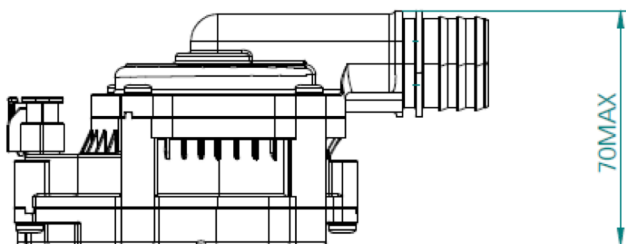
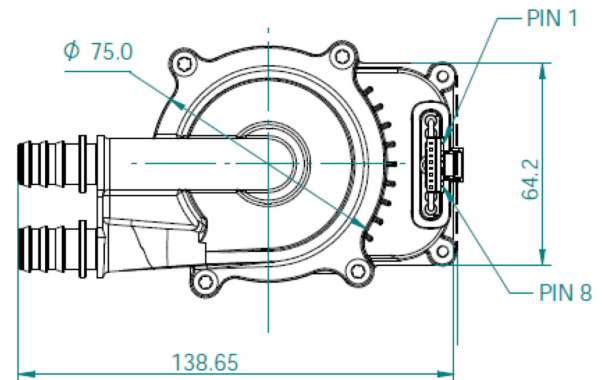
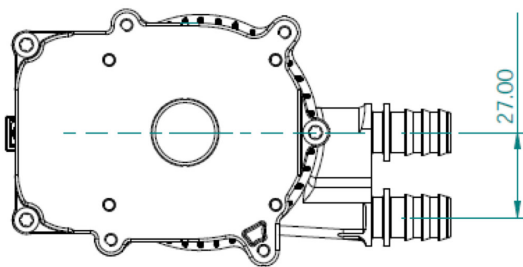

PIN ASSIGNMENT		
PIN NO	COLOR	FUNCTION
P1	RED	V+
P2	RED	V+
P3	NC	NC
P4	YELLOW	SPEED CONTROL
P5	GREEN	IN-PLACE
P6	BLUE	TACH FEEDBACK
P7	BLACK	V-
P8	BLACK	V-